

REVISIONS		
REV	DESCRIPTION	DATE

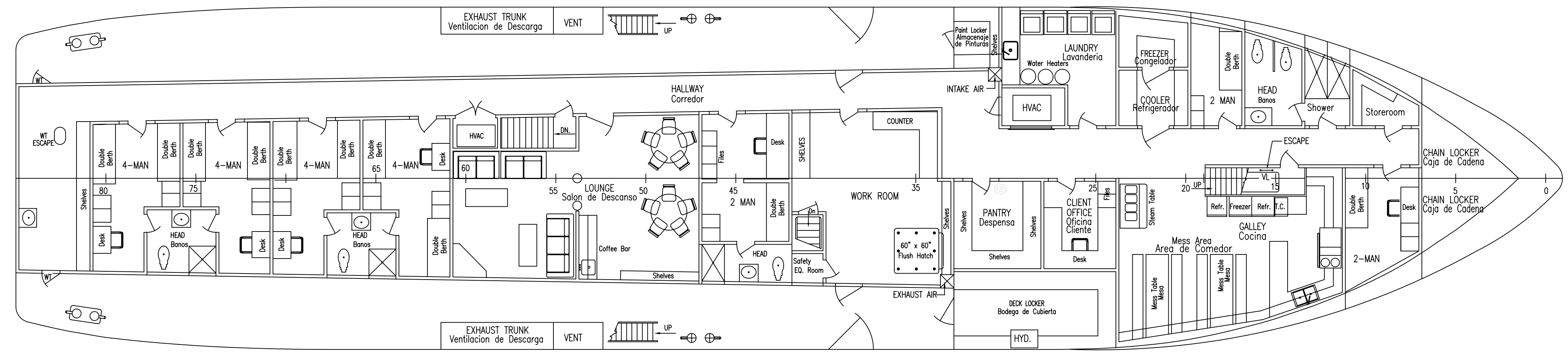

MAIN DECK
PLAN DE CUBIERTA PRINCIPAL
14'-0" ABOVE BASELINE

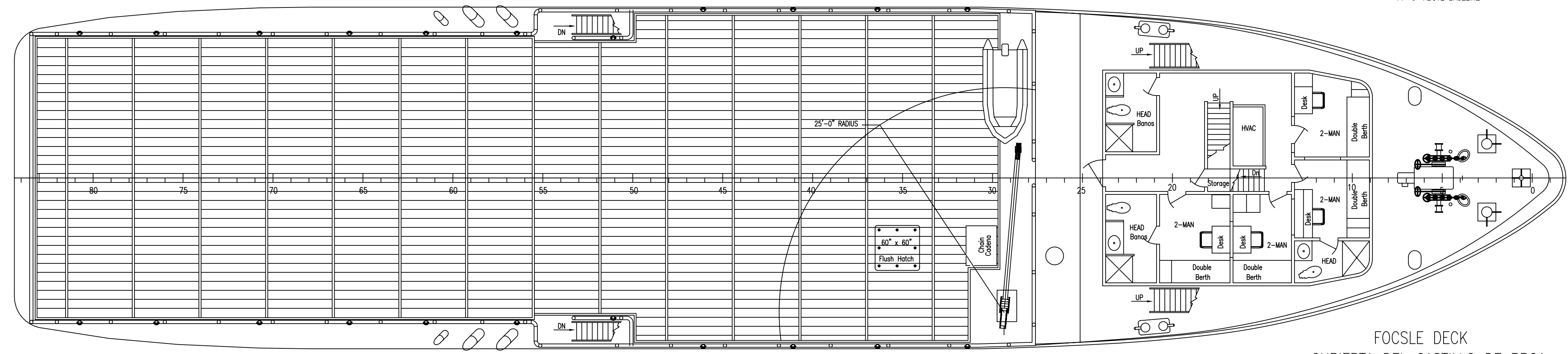

FOCSLE DECK
CUBIERTA DEL CASTILLO DE PROA
24'-0" ABOVE BASELINE

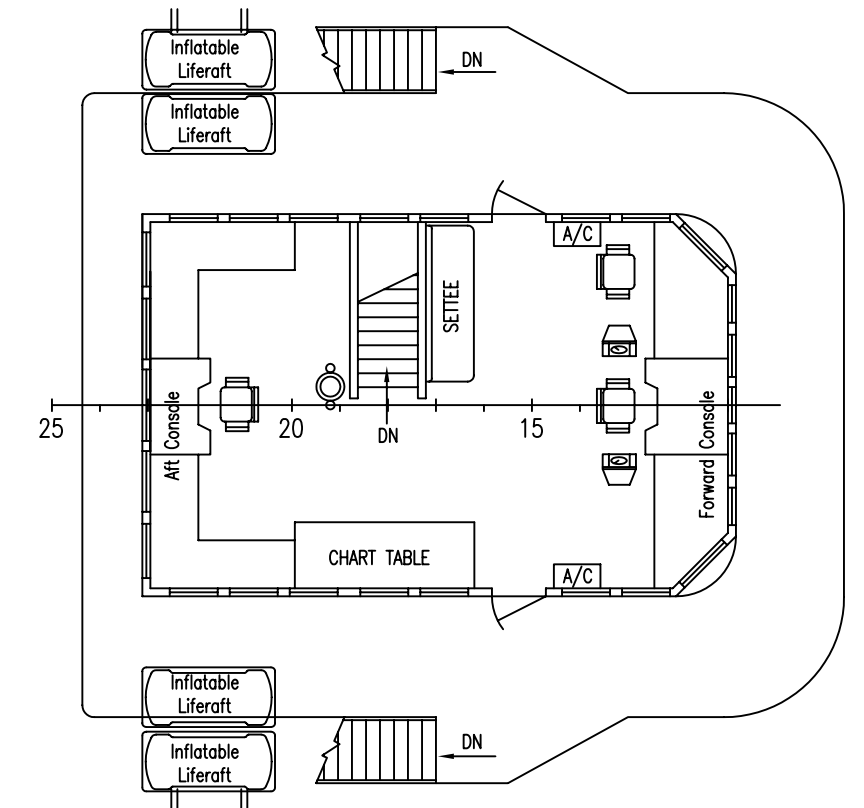

WHEELHOUSE
PUENTE
30'-5" ABOVE BASELINE

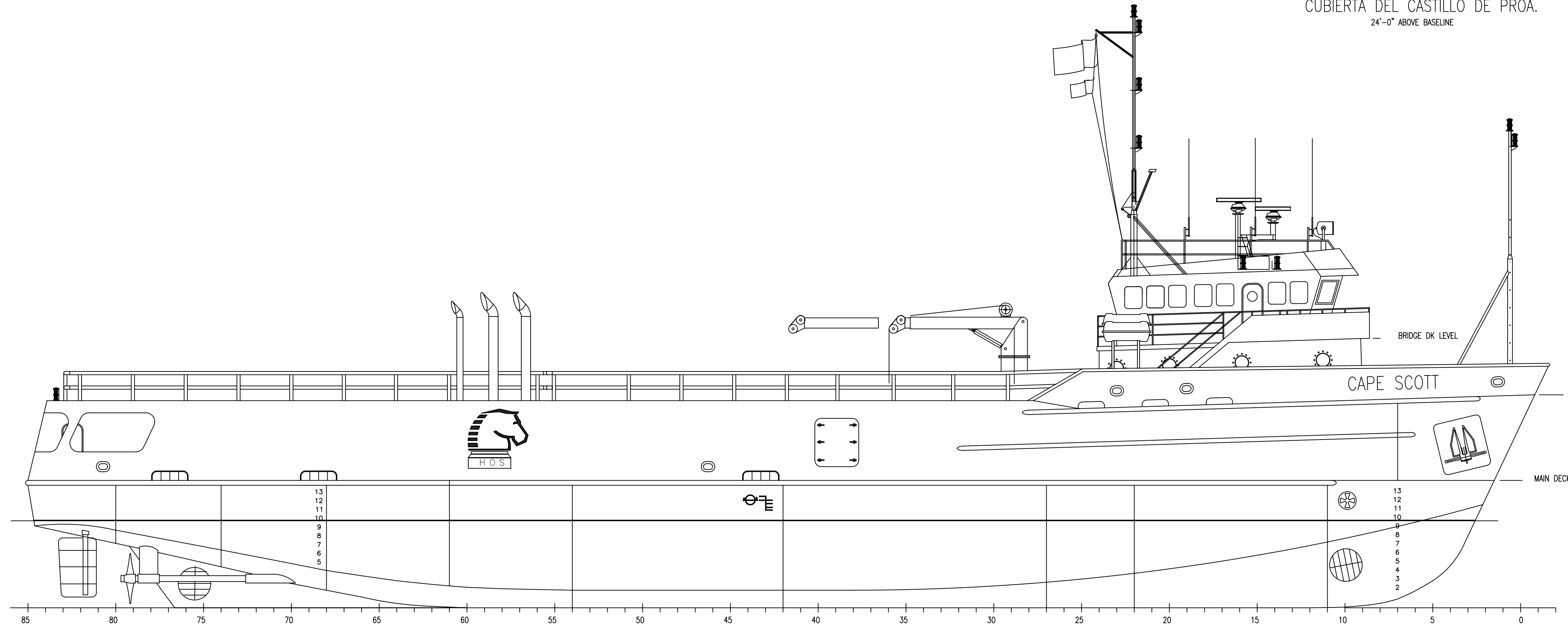

OUTBOARD PROFILE
PERFIL

HORNBECK OFFSHORE SERVICES

THIS DRAWING, DESIGN CONCEPT AND SPECIFICATIONS ARE THE PROPERTY OF HORNBECK OFFSHORE SERVICES AND ARE FURNISHED ON A CONFIDENTIAL BASIS WITH AN EXPRESSED UNDERSTANDING THAT THEY WILL NOT BE COPIED, IN ANY MANNER, USED FOR MANUFACTURE, SOLD, TRANSFERRED, NOR USED TO THE DETRIMENT OF SAID FIRM WITHOUT WRITTEN PERMISSION.

DRAWN BY:	175'-0" X 38'-0" X 14'-0"		
W. Thomas	OSV-SP CAPE SCOTT		
CH'KD. BY:	PROFILE & ARRANGEMENT		
S. Arceneaux	SCALE: 1/8" = 1' - 0"	DATE: 09-22-07	REV.
APP'D. BY:	HULL NO. BS #9317		0
PROJECT #	DRAWING # 1.001	SHEET 1 OF 1	